

# FURNITURE & HOME OFFICE

## planning guide



more **SPACE** place®

*fully customizable furniture with style, form, and function*

# WALL UNIT

More Space Place furniture and custom cabinetry is customizable to fit your style and space needs. Choose from a variety of finishes, styles and sizes to meet the way you live.

## 19" High Wall Units

Width 15"

Depth(s) 15", 20", or 24"

A & B also available in 12" depth

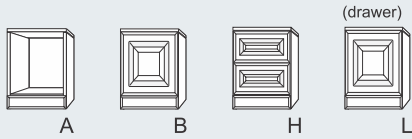

Includes bottom decorative trim. Shelves not included.

Width(s) 24", 30", or 36"

Depth(s) 15", 20", or 24"

A & B also available in 12" depth

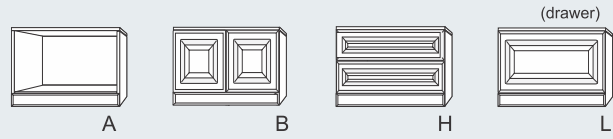

## 34" High Wall Units

Width 15"

Depth(s) 15", 20", or 24"

A & B also available in 12" depth

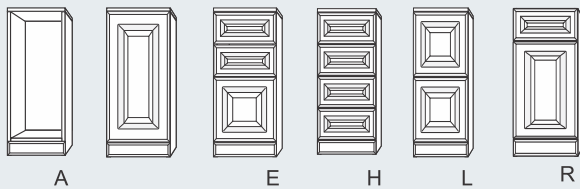

Includes bottom decorative trim. Shelves not included.

Width(s) 24", 30", or 36"

Depth(s) 15", 20", or 24"

A & B also available in 12" depth

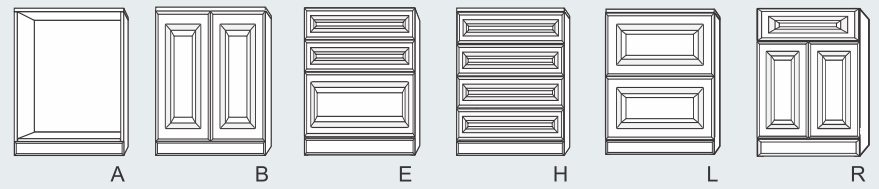

## Angle End Wall Cabinets

Available sizes (WxD):  
15" x 15" or 20" x 20"  
height: 34"



## Radius End Wall Cabinets

Available sizes (WxD):  
15" x 15" or 20" x 20"  
height: 34"

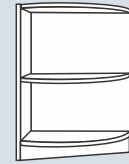

## 42" High Wall Units

Width 15"

Depth(s) 15", 20", or 24"

A, B, & C also available in 12" depth

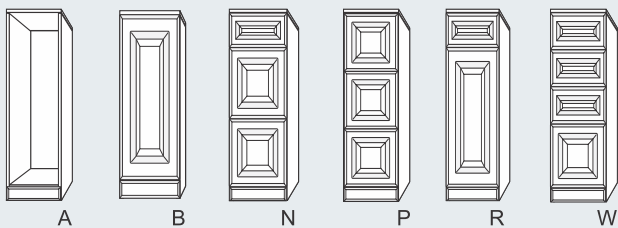

Includes bottom decorative trim. Shelves not included.

Width(s) 24", 30", or 36"

Depth(s) 15", 20", or 24"

A, & B also available in 12" depth

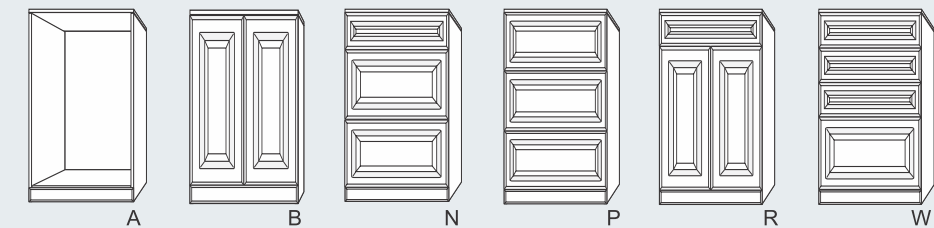

## 67" High Wall Units

Width 15"

Depth(s) 15", 20", or 24"

A, B, & C also available in 12" depth

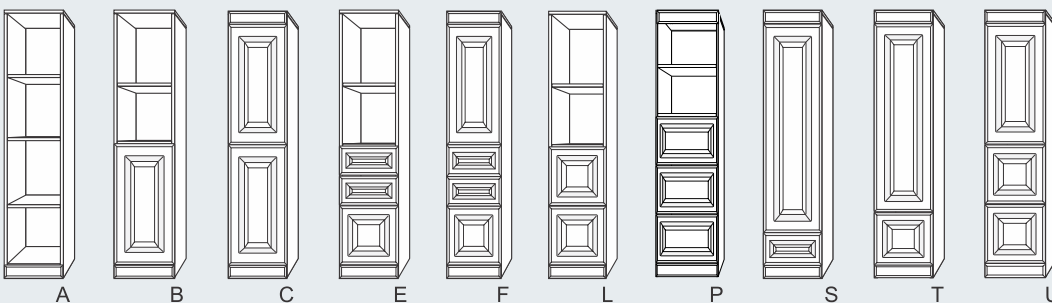

Includes:  
top & bottom decorative trim  
1 fixed shelf  
2 adjustable shelves

## 85" & 90" High Units

Angle End

Available sizes (WxD)  
15" x 15" & 20" x 20"

Radius End

Available sizes (WxD)  
15" x 15" & 20" x 20"

Radius Shelf

Available sizes (WxD)  
6" x 12"

Diagonal Corner

Available sizes (WxD)  
30" x 30" x 12"

Diagonal corner unit ava



Angle End

# WALL UNIT

All wall units are available in 15", 20" or 24" depth. A & B style cabinets are also available in 12" depth in all heights.

## 67" High Wall Units

Width(s) 24", 30", or 36"

Depth(s) 15", 20", or 24"

A, B, & C also available in 12" depth

**Includes:**

top & bottom decorative trim

1 fixed shelf

2 adjustable shelves

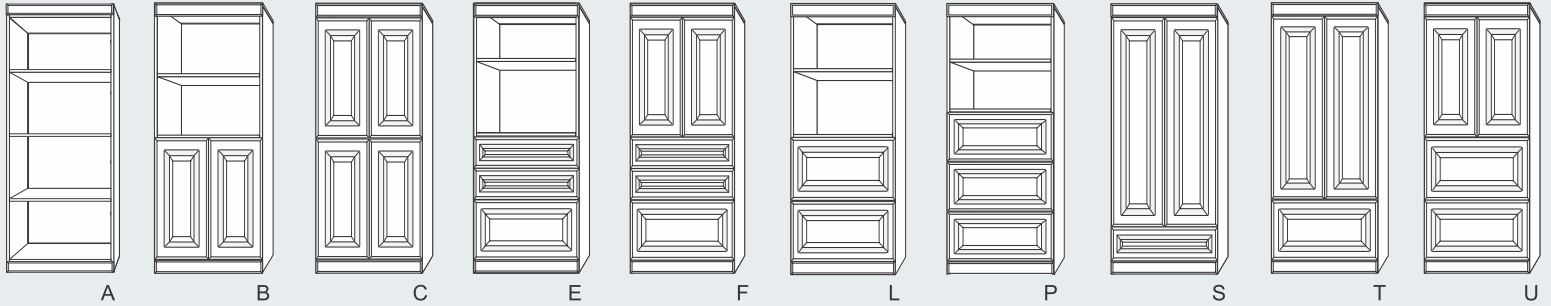

## 85" & 90" High Wall Units

Width 15"

Depth(s) 15", 20", or 24"

A, B, C, D, & K also available in 12" depth

**Includes:**

top & bottom decorative trim

2 fixed shelves

2 adjustable shelves

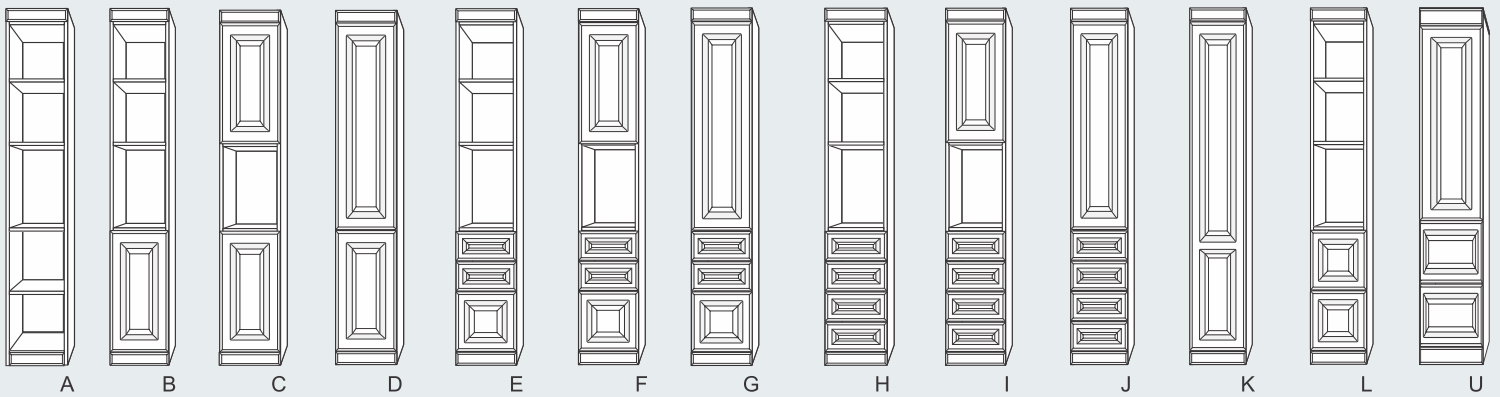

Width(s) 24", 30"

Depth(s) 15", 20", or 24"

A, B, C, D, & K  
also available in 12" depth

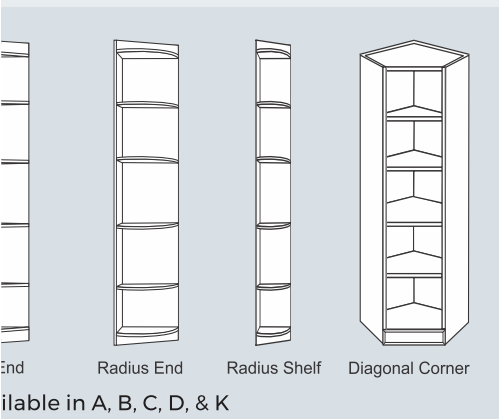
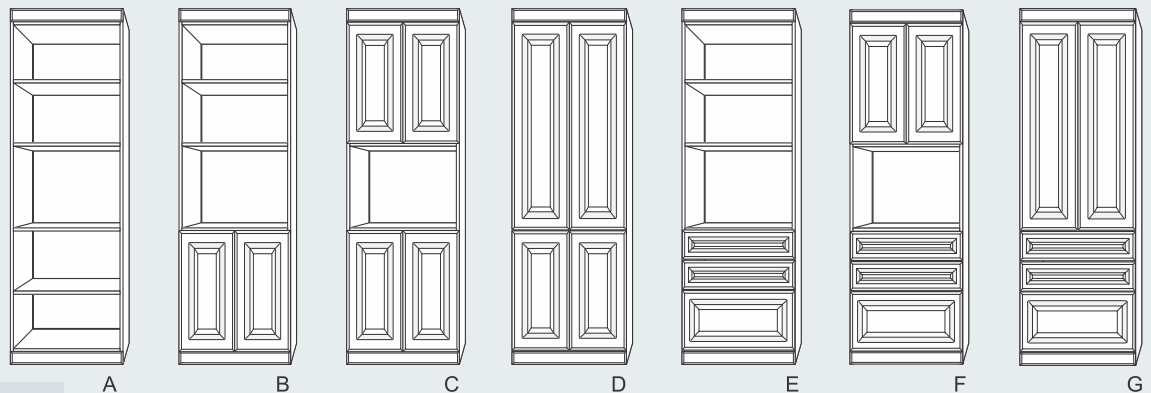

Available in A, B, C, D, & K

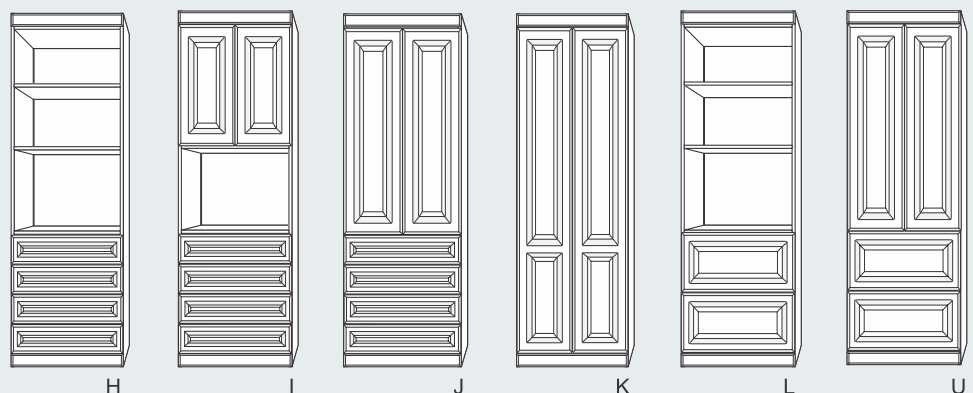

# COSMOPOLITAN TOWERS

Tower heights coordinate with twin, full, and queen bed heights. Towers are available in 15" depth only.

## 49" High Wall Units

Includes:

- top & bottom decorative trim
  - 1 fixed shelf
  - 1 adjustable shelf
- Width 15" | Depth 15"

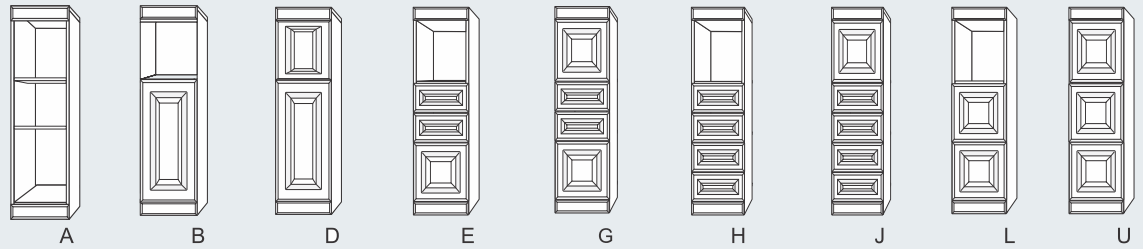

Width(s) 24", 30", or 36"  
Depth 15"

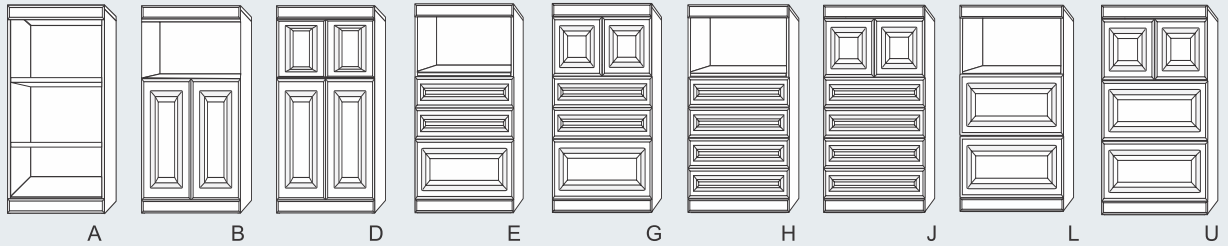

## 64" High Wall Units

Includes:

- top & bottom decorative trim
  - 1 fixed shelf
  - 2 adjustable shelves
- Width 15"

Depth 15"

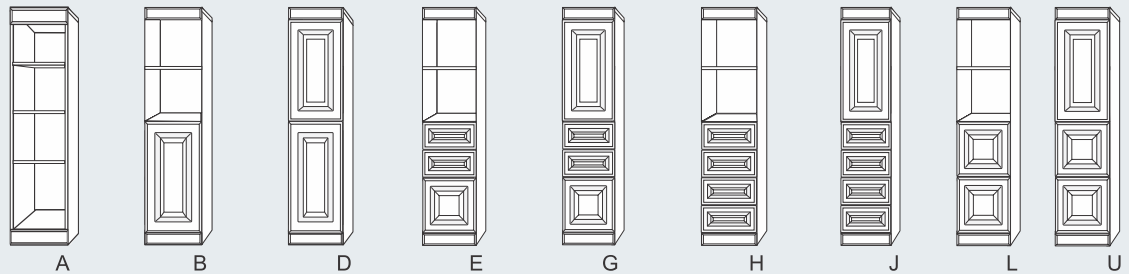

Width(s) 24", 30", or 36"  
Depth 15"

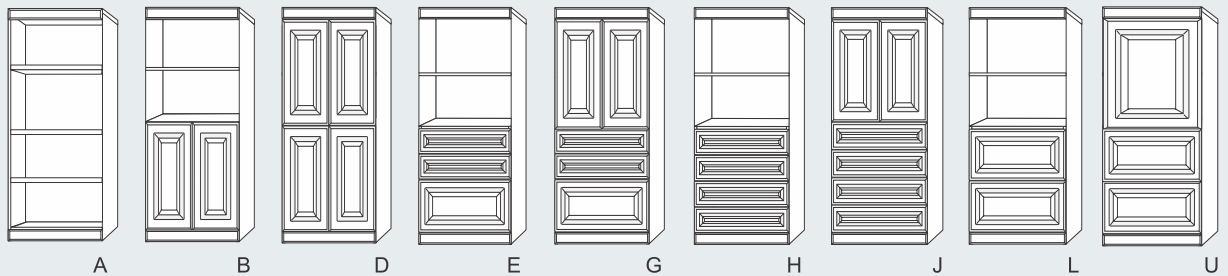

## 70" High Wall Units

Includes:

- top & bottom decorative trim
  - 1 fixed shelf
  - 3 adjustable shelves
- Width 15"

Depth 15"

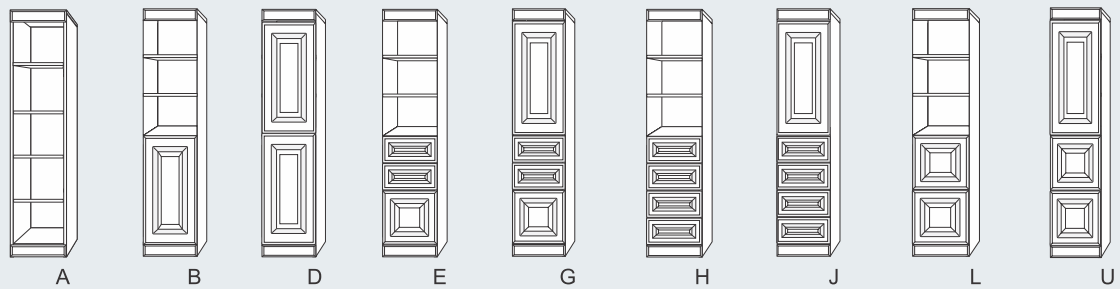

Width(s) 24", 30", or 36"  
Depth 15"



# HOME OFFICE

**base cabinets** All base cabinets are 28-7/8" height and are available in 15", 20" or 24" depths

Includes bottom decorative trim. Shelves not included.

## Standard Base Cabinets

Width(s) 15" or 17-1/4"  
Depth(s) 15", 20", or 24"

A & B also available in 12" depth

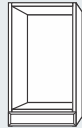

A

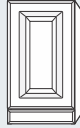

B



E



H

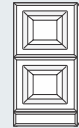

L

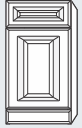

R

Width(s) 24", 30", and 36"  
Depth(s) 15", 20", or 24"

A & B also available in 12" depth

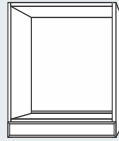

A



B or B2

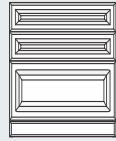

E

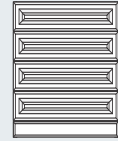

H

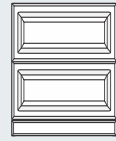

L

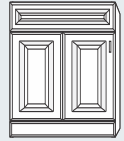

R or R2

Bi-fold door cabinets available in B2 and R2

## Base Pie Corner Unit

Width 32 1/2"  
Depth 32 1/2"  
Height 29"

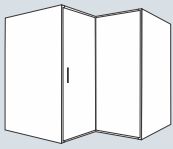

## Base Blind Corner Unit

Width 40 1/8"  
Depth 20 3/4"  
Height 29"

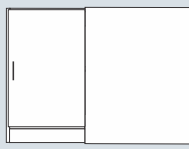

## Radius End Base Cabinet

15" x 15"  
or 20" x 20"  
Height 29"

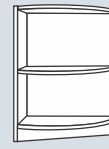

## Angle End Base Cabinet

15" x 15"  
or 20" x 20"  
Height 29"

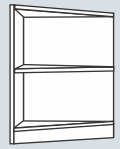

## upper cabinets

All upper cabinets are 12" deep and are available in 25" or 30" heights.

Includes 1 adjustable shelf.

### Open Uppers

Width(s) 12", 15", 18", 24", 30", or 36"

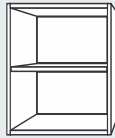

### Corner Uppers

Width 24"  
Depth 12"

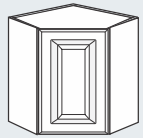
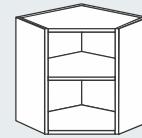

### Single Door Uppers

Width(s) 12", 15", 18", or 24"

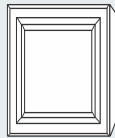
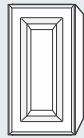

### Double Door Upper

Width(s) 24", 30", or 36"  
Depth 12"

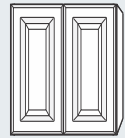

### Open Shelf Upper

Width 12"

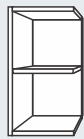

### Angle End Upper

Width 12"  
Depth 12"



### Radius End Upper

Width 6"  
Depth 12"

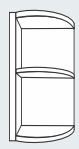

### Blind Corner Uppers

Width 36"

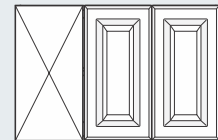
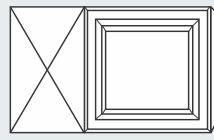
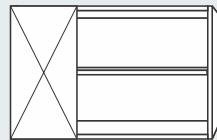

## specialty wall units

Includes 1 fixed shelf, 3 upper adjustable shelves & 1 lower full depth shelf.

### Drop-Down Lids/Desks

Width(s) 24" or 30"  
Depth(s) 15" or 20"  
Height(s) 85" or 90"

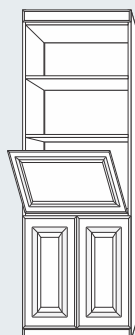

Drop Lid B

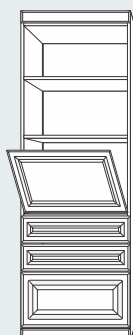

Drop Lid E

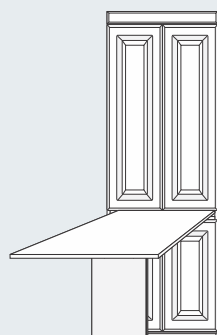

D

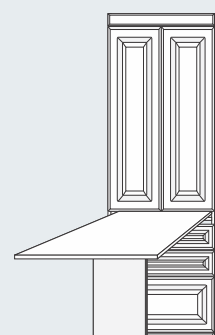

G

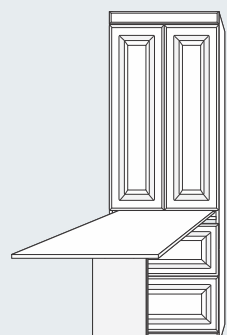

U



# ENDLESS OPTIONS

The More Space Place® furniture and custom cabinetry product line is completely customizable to fit your style and space needs. Mix and match from a wide variety of finishes and furniture styles. Combine cabinets with an infinite number of bed and accessory configurations. With the help of our experienced Design Staff we can help you Make Room for Life®.

## custom doors & drawer fronts

Add a decorative touch with laminate, thermofoil or premium wood doors and drawer fronts. Available in a large selection of contemporary, traditional, and shake styles. For a full list of styles and finishes, consult with your More Space Place® specialist.

## molding and trim

Finish your custom look with premium wood or laminate trim. Available with optional rope or dentil details in matching finishes.

crown molding

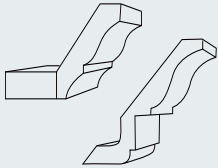

fluted trim

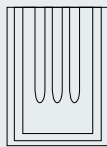

rope molding



dentil molding



## countertops

More Space Place® offers custom countertops in laminate, solid surface, and natural granite options to fit your personal needs and style. Options and finishes available may vary by store.

## lighting

Enhance your design with Accent and Functional LED lighting, available in a variety of styles and light tones.



Schedule a complimentary consultation today. Visit us online to find a showroom near you: [morespaceplace.com](http://morespaceplace.com)

Murphy Beds • Closets • Home Offices • Garages • Laundry Rooms  
Mud & Utility Rooms • TV & Wall Units • Pantries

2020 More Space Place.  
National network of independently owned and operated franchises.

# SPACE SAVING HOME FURNISHINGS

A home office and wall bed combination maximizes space and creates two functional areas in one room! Easily convert from an efficient work space to comfortable guest accommodations.

Customize your design to meet your needs in your choice of finish, size, and style.

